

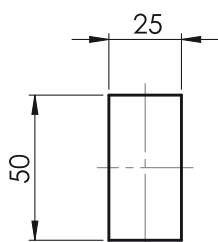

Zamki różne

Zamek dociskowy

020

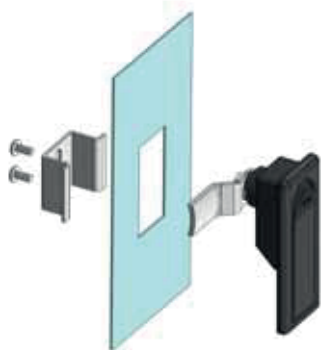

Otwór montażowy

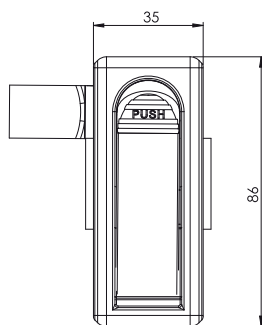
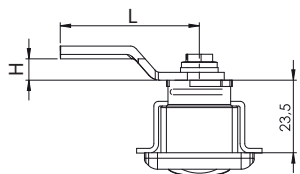

Typ zamka

020

Język

CM



Zamek dociskowy

021

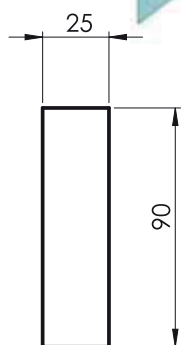
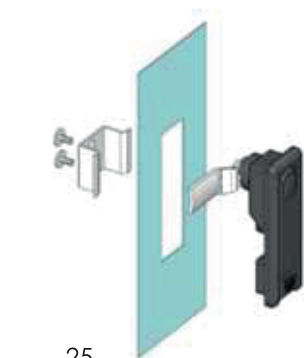

Otwór montażowy

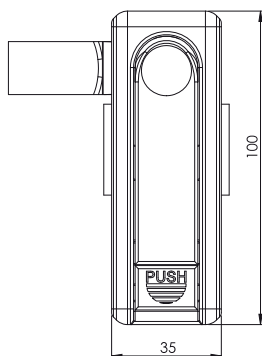
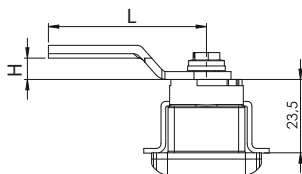

Typ zamka

021

Język

CM



Materiał

Korpus : Poliamid  
 Język : Stal

Języki bez ogr. (CM)

Kod	011	013	014	016	056	057	062	065	034
H	8	0	4	0	4	5	-6	5	0
L	50	44	42	54	52	77	52	85	36

